

OWL V-LATCH SURFACE HEAD ASSEMBLY | **NWL/3**

ASSEMBLIES	DESCRIPTION	PART NUMBER	WEIGHT	
			lb	kg
A	Head assy NWL/3 OWL V-L	10S-N10-005VL	22.04	10.00
B	Inner tube cap assy NWL/3/U OWL	10S-N10-031	3.08	1.40



	DESCRIPTION	PART NUMBER	
A	Spearhead point	10S-10-006	
	Compression spring	10S-10-009	
	Detent plunger	10S-10-010	
	Spiral pin 7/16" X 1"	10S-10-008	
	Spearhead base	10S-N10-011	
	Coiled spring pin 1/2" X 2"	10S-N10-012SL	
	Coiled spring pin 3/8" X 2"	10S-H10-018SL	
	Latch retracting case	10S-N10-013SL	
	Spring lock nut	10S-N10-071SL	
	Piston compression spring	10S-N10-014SL	
	Piston	10S-N10-070VL	
	Latch (2)	10S-N10-015VL	
	Spring pin 1/2" X 1-1/2"	10S-10-017	
	Upper latch body	10S-N10-19USL	
	Landing shoulder	10S-N10-19S	
	Landing indicator bushing	10S-10-016	
	Stainless steel ball 22mm	10S-10-052	
	Lower latch body	10S-N10-19L	
	Hex nut	10S-N10-020	
	Spindle shaft	10S-N10-021	
	1 Shut-off valve hard (2)	10S-N10-22H	
	Valve adjusting washer (2)	10S-N10-023	
	Ball thrust bearing	10S-N10-025	
	Spindle bearing	10S-N10-026	
	Hanger bearing	10S-N10-027	
	Compression spring	10S-N10-028	
	Lock nut	10S-N10-030	
	B	Inner tube cap	10S-N10-31B
		Grease fitting 1/4"- 28 straight	10S-10-31G
		Stainless steel ball 22mm	10S-10-052
		Check valve body	10S-10-31C

1 Optional shut-off valves (soft) are also available. Please use the following part number 10S-N10-22S to place an order.

## OWL V-LATCH SURFACE | NWL/3 PARTS

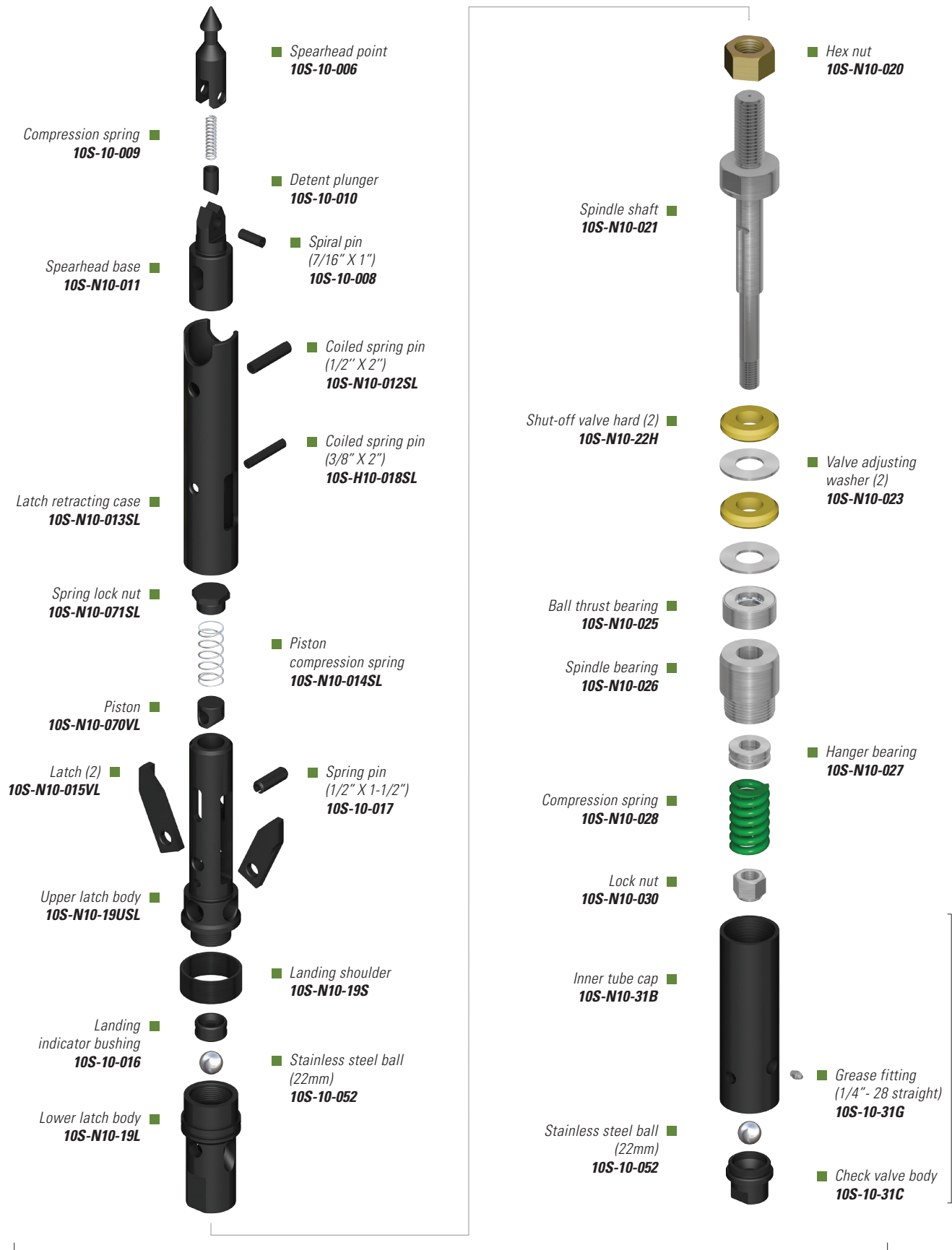

**A**

**B**